

Please read and save these instructions. Read through this owner's manual carefully before using product. Protect yourself and others by observing all safety information, warnings, and cautions. Failure to comply with instructions could result in personal injury and/or damage to product or property. Please retain instructions for future reference.



HEAVY DUTY SERVICE CART 46" X 25" X 33" 500 LB. CAPACITY

FOR CUSTOMER SERVICE

Technical Question?

CALL 1-866-458-2472
customerservice@oem-tools.com

UNPACKING

After unpacking unit, inspect carefully for any damage that may have occurred during transit. Check for loose, missing, or damaged parts. If any damage is observed, a shipping damage claim must be filed with carrier. Do not use the OEMTOOLS® Heavy Duty Service Cart if broken, bent, cracked or damaged parts (including labels) are noted. Any Heavy Duty Service Cart that appears damaged in any way, operates abnormally or is missing parts should be removed from service immediately. If you suspect that the Heavy Duty Service Cart was subjected to shock load (a load that was dropped suddenly, unexpectedly, etc.) immediately discontinue use until it has been checked by a factory authorized service center.



⚠ WARNING

The following safety information is provided as a guideline to help you operate your Heavy Duty Service Cart under the safest possible conditions. Any tool or piece of equipment can be potentially dangerous to use when safety or safe handling instructions are not known or not followed. The following safety instructions are to provide the user with the information necessary for safe use and operation. Please read and retain these instructions for the continued safe use of your service system. Failure to follow instructions listed below may result in serious injury. In addition, make certain that anyone that uses the equipment understands and follows these safety instructions as well.

Explanation of Safety Signal Words

⚠ WARNING: Indicates a potentially hazardous situation which, if not avoided, could result in death or serious injury.

⚠ CAUTION: Indicates a potentially hazardous situation which, if not avoided, may result in minor or moderate injury.

CAUTION: Used without the safety alert symbol indicates a potentially hazardous situation which, if not avoided, may result in property damage.

NOTES: Provide clarity and helpful information.

Thank you very much for choosing an OEMTOOLS Product!

For future reference, please complete the owner's record below:

Model: _____ **Purchase Date:** _____

Save the receipt, warranty and these instructions. It is important that you read the entire manual to become familiar with this product before you begin assembly. This Heavy Duty Service Cart is designed for certain applications only. OEMTOOLS cannot be responsible for issues arising from modification. We strongly recommend this Heavy Duty Service Cart is not modified and/or used for any application other than that for which it was designed. If you have any questions relative to a particular application, DO NOT use the Heavy Duty Service Cart until you have first contacted OEMTOOLS to determine if it can or should be performed on the product.

For technical questions please call 1-866-458-2472.



HEAVY DUTY SERVICE CART 46" X 25" X 33" 500 LB. CAPACITY



IMPORTANT INSTRUCTIONS AND SAFETY RULES

1. Read this manual carefully. Learn the product's applications and limitations, as well as, potential hazards specific to it.
2. Keep work area clean and well lit. Cluttered or dark work areas invite accidents.
3. Keep children away. All children should be kept away from the work area. Never let a child be in a work area without strict adult supervision.
4. Do not operate this product if under the influence of alcohol or drugs. Read warning labels on prescriptions to determine if your judgment or reflexes are impaired while taking drugs. If there is any doubt, do not attempt to operate.
5. Use safety equipment. Use ANSI approved safety glasses. Everyday eyeglasses are NOT safety glasses. Dust mask, non-skid safety shoes, hard hat or hearing protection should be used in appropriate conditions.
6. Wear proper apparel. Loose clothing, gloves, neck-ties, rings, bracelets or other jewelry may present a potential hazard.
7. Don't overreach. Keep proper footing and balance at all times when using this product.
8. Check for damage. Check your product regularly. If the product is damaged it should be carefully inspected to make sure that it can perform its intended function correctly. If in doubt, the part should be repaired. Refer all servicing to a qualified technician. Consult your dealer for advice.
9. Store idle equipment out of the reach of children and untrained persons. (Products may be dangerous in the hands of untrained users.)
10. Maintain product with care.
11. Do not use damaged products. Tag damaged products "Do not use" until repaired.
12. Use the right product for the job. There are certain applications for which the Heavy Duty Service Cart was designed. Do not modify the Heavy Duty Service Cart or use it for a purpose for which it is not intended.
13. When servicing, only use identical replacement parts. Use of any other parts will void the warranty.
14. Do not exceed the product's maximum load capacity of 500 Lbs.
15. Only use on a flat service capable of supporting the Heavy Duty Service Cart and its maximum capacity load of 500 Lbs. It is easy to lose control of the Heavy Duty Service Cart if attempting to pull a load on a sloped or uneven surface.
16. Do not allow children to play on, stand upon or climb on the Heavy Duty Service Cart. The Heavy Duty Service Cart is not intended for carrying people or animals.
17. Always check hardware and assembled parts after assembling. All connections should be tight and hardware tightened.
18. Always distribute objects in the Heavy Duty Service Cart evenly. Uneven weight distribution could cause the Heavy Duty Service Cart to tip over.
19. Do not lean or climb on the Heavy Duty Service Cart.
20. Keep the work area free of obstructions, grease, oil, trash, and other debris. Do not use this product in a damp or wet location.
21. Maintain labels and nameplates on this product. These carry important information. If unreadable or missing, contact OEMTOOLS for a replacement.

NOTE: The manufacturer declines any and all responsibility for damage to vehicles or components if said damage is the result of unskillful handling by the operator or of failure to observe the basic safety rules set forth in the instruction manual.

WARNING

Read Rules for Safe Operation and Instructions Carefully.

IMPORTANT SAFETY INSTRUCTIONS

The warnings, precautions, and instructions discussed in this manual cannot cover all possible conditions and situations that may occur. The operator must understand that common sense and caution are factors which cannot be built into this product, but must be supplied by the operator.

WARNING

1. Use only replacement parts and accessories sold by the manufacturer. Use of any other parts will void the warranty.
2. There are certain applications for which the Heavy Duty Service Cart was designed. Do not modify the Heavy Duty Service Cart or use it for purposes which it is not intended.
3. Before using any product, check for damaged parts. Any part that appears damaged should be carefully checked to determine if it will operate properly. Replace or repair damaged or worn out parts immediately.
4. Always wear ANSI approved impact safety eye protection.
5. When not in use, store product in a safe and clean location away from children or untrained persons.
6. Do not operate the Heavy Duty Service Cart under the influence of alcohol or drugs. Read warning labels on prescriptions to determine if your judgment or reflexes may be impaired while taking the drug(s). If in doubt, do not operate the product.
7. Do not exceed the product's maximum capacity of 500 Lbs.
8. Only use on a flat surface capable of supporting the Heavy Duty Service Cart and its maximum capacity load of 500 Lbs.
9. It is easy to lose control of the Heavy Duty Service Cart if attempting to pull a load on a sloped or uneven surface.
10. Do not allow children to play on, stand upon or climb on the Heavy Duty Service Cart. The Heavy Duty Service Cart is not intended for carrying people or animals.
11. Always check hardware and assembled parts after assembling. All connections should be tight and hardware tightened.
12. Always distribute objects in/on the Heavy Duty Service Cart evenly. Uneven weight distribution may cause the Heavy Duty Service Cart to tip over.
13. Do not lean or climb on the Heavy Duty Service Cart.

PURPOSE

This OEMTOOLS 2-shelf service cart is strong enough for heavy use. The cart is made from tough polypropylene and is easy to clean. It resists rust, denting and chipping. The Service Cart has a maximum weight carrying capacity of 500 Lbs. (250 Lbs. per shelf) and smooth rolling, non-marring 5" casters make for easy pushing. Plus the handle has a hardware bin and cup holder for even more storage.



HEAVY DUTY SERVICE CART

46" X 25" X 33"

500 LB. CAPACITY

PRODUCT SPECIFICATIONS

| | |
|-----------------------------|---|
| Maximum Capacity: | 500 Lbs. |
| Tray Size: | 37.2" (L) x 25.7" (W) x 4" (H) |
| Cart Size: | 46.1" (L) x 25.6" (W) x 33" (H) |
| Non-Marring Casters: | (2) Fixed and (2) Swivel, 5" Diameter x 1" Wide |

NOTE: The Heavy Duty Service Cart is made with industrial duty Polypropylene and is maintenance free. It won't rust, chip or dent. The Large Hi-Impact Service Cart comes with a tool and cup holder handle.

ASSEMBLY

The OEMTOOLS Service Cart will require complete assembly. It is important that you read the entire manual to become familiar with the product BEFORE you assemble and use the Service Cart. Before operating the Service Cart, be sure that you have all the parts included in the Parts List and shown in the Product Blow Out on the next page of the manual.

- Place one Tray (3) upside down on the work surface. Locate the Handle (5). Turn it upside down with the cup holder toward the Tray (3) and the hand holes on the outside. Using a rubber mallet (not included), tap the Handle (5) down into the grooves on the Tray (3) - see Figure A.
- Locate the two Beams (7). Place one on the Tray (3) corner nearest the Handle (5), and place one on the diagonal corner located on the outside of the Tray (3) as in the Assembly diagram. Make certain that the end with the screw holes is facing upward. Using a rubber mallet, tap the Beams (7) down into the Tray (3). Note: Position the Beams so that the flange in each matches the space in the Tray (3). - see Figure B.
- Locate the two Beams (8). Place one on the Tray (3) corner nearest the Handle (5), and place one on the diagonal corner located on the outside of the Tray (3) as in the Assembly diagram. Make certain that the end with the screw holes is facing upward. Using a rubber mallet, tap the Beams (8) down into the Tray (3). - see Figure B.
- Inserts Screws (4) down through each Beam (7) and Beam (8) and into the Tray (3) - see Figure B.
- Locate the second Tray and turn it upside down. Set the second Tray (3) onto the Beams (7 & 8) making certain that both Trays (3) are facing the same way. Insert Screws (4) down through the Tray (3) into each Beam (7) and Beam (8) - see Figure C.
- Turn the Service Cart right-side up. Set the Corner Covers (1 and 2) down into each corner of the top Tray (3) - see Assembly diagram.
- Turn the Service Cart upside down again. As necessary, attach one Caster (11) to each of the two Brackets of Swivel Caster (9) using one Bolt (12) and secure it in place with Nut (10) - see Assembly diagram.
- As necessary, attach one Caster (16) to each of the two Brackets of Fixed Caster (13) with Bolt (12), and Nut (10).

- Place the two Brackets of Swivel Caster on the same side of the Tray as the Handle (5), and place the two Fixed Casters on the rest side of the Tray- see Figure D.
- Thread Bolts (17) down through the Tray (3) and into the Casters (9 and 13). Slide on Split Washer (14) and thread on Nuts (16).
- Turn the Service Cart upright. Make certain that all hardware is tight. Make certain that the Fixed Casters and Swivel Casters roll properly.

Assembly Diagram

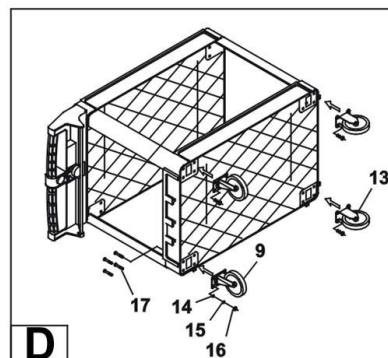
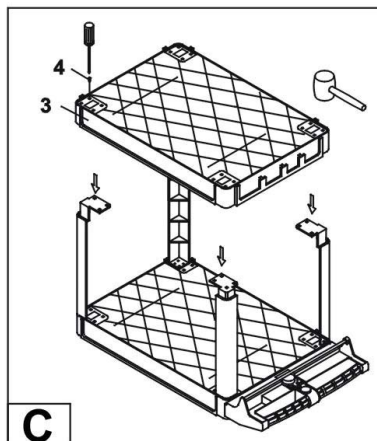
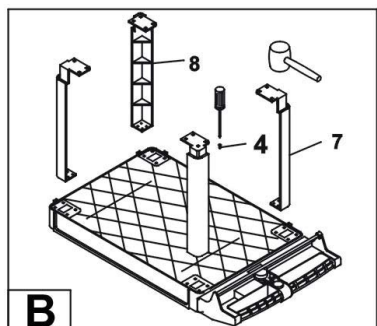
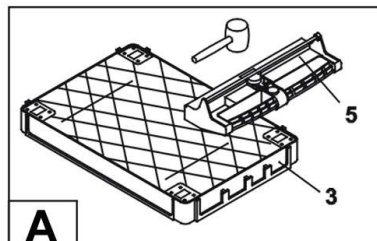



HEAVY DUTY SERVICE CART

46" X 25" X 33"

500 LB. CAPACITY

| Item # | Part Name | Quantity |
|--------|--------------------------|----------|
| 1 | Corner Cover | 2 |
| 2 | Corner Cover | 2 |
| 3 | Tray | 2 |
| 4 | Screw | 8 |
| 5 | Handle | 1 |
| 7 | Beam | 2 |
| 8 | Beam | 2 |
| 9 | Bracket of Swivel Caster | 2 |
| 10 | Nut | 4 |
| 11 | Caster | 4 |
| 12 | Screw | 4 |
| 13 | Bracket of Fixed Caster | 2 |
| 14 | Washer | 16 |
| 16 | Caster | 16 |
| 17 | Screw | 16 |
| 18 | Rod | 1 |

Parts Diagram

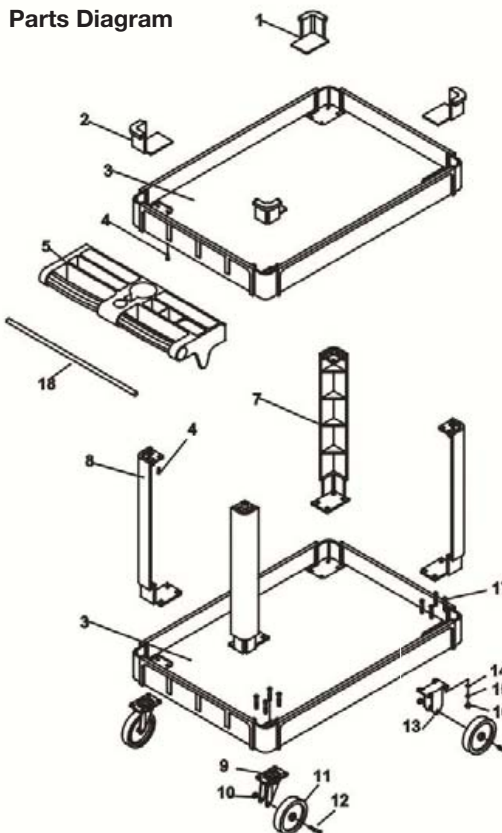

NOTE: Not all components of the Heavy Duty Service Cart are replacement items, but are illustrated as a convenient reference for location and position in the assembly sequence.

OEMTOOLS® ONE YEAR WARRANTY

If for up to one year from the date of purchase of this OEMTOOLS product you find any defect in material or workmanship, through normal usage, return it to the place of purchase, or to OEMTOOLS for repair or replacement at our discretion. In order to obtain this service send your tool and proof of purchase, transportation pre-paid, to OEMTOOLS Q.A. Dept, 3580 E. Raines Road #3, Memphis, TN 38118. We will not be responsible for lost or damaged goods during transportation, please insure your package. If our inspection verifies the defect, we will either repair or replace the product at our election, or we may elect to refund the purchase price if we cannot readily and quickly provide you with a replacement. We will return repaired products at our expense, but if we determine there is no defect, or that the defect resulted from causes not within the scope of our warranty, then you must bear the cost of returning the product.

OEMTOOLS does not provide warranty for products labeled other than OEM or OEMTOOLS. OEMTOOLS will not provide any warranty for products subjected to abnormal use. Abnormal use includes, but is not limited to, abuse, accident, alteration, neglect, and unauthorized or unreasonable use or repairs. This warranty does not cover bits, blades, files, batteries, or calibration. We recommend that you maintain your tools and sharpen or replace blades, bits, files, and batteries as necessary. OEMTOOLS reserves the right to make any changes in construction or design at any time without any obligation in incorporating such changes to tools or equipment previously sold.

OEMTOOLS makes every effort to assure that its products meet high quality and durability standards, and warrants to the original purchaser that this product is free from defects in materials and workmanship for the period of one year from the date of purchase. This warranty does not apply to damage due directly or indirectly to misuse, abuse, negligence or accidents, repairs or alterations outside our facilities, criminal activity, improper installation, normal wear and tear or to lack of maintenance.

We shall in no event be liable for death, injuries to persons or property, or for incidental, contingent, special or consequential damages arising from the use of our product. Some states do not allow the exclusion or limitation of incidental or consequential damages, so the above limitation of exclusion may not apply to you. THIS WARRANTY IS EXPRESSLY IN LIEU OF ALL OTHER WARRANTIES, EXPRESS OR IMPLIED, INCLUDING THE WARRANTIES OF MERCHANTABILITY AND FITNESS. This warranty gives you specific legal rights, and you may also have other rights, which vary from state to state.



3580 E. Raines Road, Suite 3, Memphis, TN 38118
 Tel: 1-866-458-2472
 www.oem-tools.com

