

Please read and save these instructions. Read through this owner's manual carefully before using product. Protect yourself and others by observing all safety information, warnings, and cautions. Failure to comply with instructions could result in personal injury and/or damage to product or property. Please retain instructions for future reference.



1100 LB. ENGINE SUPPORT BAR

FOR CUSTOMER SERVICE

Technical Question?

CALL 1-866-458-2472
customerservice@oem-tools.com

UNPACKING

After unpacking the unit, inspect carefully for any damage that may have occurred during transit. Check for loose, missing, or damaged parts. If any damage is observed, a shipping damage claim must be filed with the carrier. DO NOT use the OEMTOOLS™ 24950 1100 Lb. Engine Support Bar if broken, bent, cracked or damaged parts (including labels) are noted. Any Engine Support Bar that appears damaged in any way, operates abnormally or is missing parts should be removed from service immediately. If you suspect that the Engine Support Bar was subjected to shock load (a load that was dropped suddenly, unexpectedly, etc.), immediately discontinue use until it has been checked by a factory authorized service center.



⚠ WARNING

The following safety information is provided as a guideline to help you operate your Engine Support Bar under the safest possible conditions. Any tool or piece of equipment can be potentially dangerous to use when safety or safe handling instructions are not known or not followed. The following safety instructions are to provide the user with the information necessary for safe use and operation. Please read and retain these instructions for the continued safe use of your Engine Support Bar. Failure to follow instructions listed below may result in serious injury. In addition, make sure that anyone who uses the equipment understands and follows these safety instructions as well.

Explanation of Safety Signal Words

⚠ WARNING: Indicates a potentially hazardous situation which, if not avoided, could result in death or serious injury.

⚠ CAUTION: Indicates a potentially hazardous situation which, if not avoided, may result in minor or moderate injury.

CAUTION: Used without the safety alert symbol indicates a potentially hazardous situation which, if not avoided, may result in property damage.

NOTES: Provide clarity and helpful information.

Thank you very much for choosing an OEMTOOLS™ Product!

For future reference, please register your new tool at www.oem-tools.com and complete the owner's record below:

Model: _____ **Purchase Date:** _____

Save the receipt, warranty and these instructions. It is important that you read the entire manual to become familiar with this product before you begin using it. This product is designed for certain applications only. OEMTOOLS™ cannot be responsible for issues arising from modification. We strongly recommend this product is not modified and/or used for any application other than that for which it was designed. If you have any questions relative to a particular application, DO NOT use the product until you have first contacted customer service to determine if it can or should be performed on the product.

⚠ WARNING: Pursuant to California Proposition 65, this product contains chemicals known to the state of California to cause cancer and birth defects or other reproductive harm. Wash hands after handling.



1100 LB. ENGINE SUPPORT BAR

! IMPORTANT INSTRUCTIONS AND SAFETY RULES

1. Know your product. Read this manual carefully. Learn the product's applications and limitations as well as potential hazards specific to it.
2. Keep work area clean and well lit. Cluttered or dark work areas invite accidents.
3. Keep children away. All children should be kept away from the work area. Never let a child handle tools or equipment without strict adult supervision.
4. DO NOT operate this product if under the influence of alcohol or drugs. Read warning labels on prescriptions to determine if your judgment or reflexes are impaired while taking drugs. If there is any doubt, DO NOT attempt to operate.
5. Use safety equipment. Eye protection should be worn at all times when operating this tool. Use ANSI approved safety glasses. Everyday eyeglasses are NOT safety glasses. Dust mask, non-skid safety shoes, hard hat or hearing protection should be used in appropriate conditions.
6. Wear proper apparel. Loose clothing, gloves, neck-ties, rings, bracelets or other jewelry may present a potential hazard when operating this product. Keep all apparel clear of the product.
7. DO NOT overreach. Keep proper footing and balance at all times when operating this product.
8. Check for damage. Check equipment regularly. If part of the product is damaged, it should be carefully inspected to make sure that it can perform its intended function correctly. If in doubt, discontinue use of product.
9. Keep away from flammables. DO NOT attempt to operate this product near flammable materials or combustibles. Failure to comply may cause serious injury or death.
10. Store this product out of the reach of children and untrained persons. This product may be dangerous in the hands of untrained users.
11. Keep this product dry and clean.
12. Use only accessories that are recommended by the manufacturer for your model. Accessories that may be suitable for one product may become hazardous when used on another product.
13. Service must be performed only by qualified repair personnel. Service or maintenance performed by unqualified personnel could result in a risk of injury.
14. When servicing a product, use only identical replacement parts. Use of unauthorized parts or failure to follow maintenance instructions may create a risk of injury.
15. Maintain a safe working environment. Keep the work area well lit. Make sure there is adequate surrounding workspace. Keep the work area free of obstructions, grease, oil, trash, and other debris. Do not use this product in a damp or wet location.
16. Maintain labels and nameplates on this product. These carry important information. If unreadable or missing, contact OEMTOOLS™ for a replacement.
17. Keep this product dry, clean, and free from brake fluid, oil, and grease.

18. Avoid accidental fire. DO NOT smoke near this product.
19. The warnings, precautions, and instructions discussed in this manual cannot cover all possible conditions and situations that may occur. The operator must understand that common sense and caution are factors which cannot be built into this product, but must be supplied by the operator.
20. We believe the information contained herein to be reliable. However, general technical information is given by us without charge and the user shall employ such information at their own discretion and risk. We assume no responsibility for results or damages incurred from the use of such information in whole or in part.
21. The manufacturer declines any and all responsibility for property damage or injury if said damage is the result of unskillful handling by the operator or of failure to observe the basic safety rules set forth in the instruction manual.
22. The procedures documented in this manual are to serve as guidelines for the use of this equipment.
23. The use of this equipment is simple and straightforward if you follow the instructions. When operating this equipment, use common sense, and only use this equipment for its intended purpose.

PRODUCT DESCRIPTION

The OEMTOOLS™ 24950 1100 Lb. Engine Support Bar is designed to support the weight of the engine while performing drive line maintenance and repairs.

PRODUCT SPECIFICATIONS

Maximum Capacity	1100 Lbs. (498 kg)
Maximum Spread	58-1/4" (1480 mm)
Minimum Spread	28-3/4" (728 mm)
Applications	Passenger vehicles and light trucks

CONTENTS

1. Engine Support Bar Assembly
2. Instruction Manual

SPECIFIC SAFETY INSTRUCTIONS

! WARNING: Thoroughly read and understand the provided product manual before attempting to use this product.

1. DO NOT exceed maximum load capacity (1100 lbs. / 498 kg).
2. Ensure all lock knobs, nuts and bolts are tightened securely prior to applying load.
3. Prior to applying load, ensure the load is properly secured to the Engine Support Bar.
4. NEVER work under a lifted load.
5. DO NOT place fingers, hands or any part of the body under the lifted load, or between the load and another surface.
6. DO NOT attempt to modify the Engine Support Bar. This may impair the strength and balance of the bar, leading to product failure.





1100 LB. ENGINE SUPPORT BAR

7. DO NOT move the vehicle, engine or engine supports while the Engine Support Bar is supporting the weight of the Engine.
8. DO NOT leave the engine suspended for long periods of time. This tool is intended for use during maintenance, not for engine storage.
9. ALWAYS inspect the Engine Support Bar before each use. Discontinue use immediately if the unit is bent, broken or damaged in any way.
10. Imbalanced loading, swinging or sudden drops can generate dynamic loading, which may lead to product failure.
11. Personal Protective Equipment: ALWAYS wear ANSI approved impact safety goggles, a full-face impact rated safety shield and heavy-duty work gloves while performing any vehicle maintenance or repair.

ASSEMBLY INSTRUCTIONS

1. Unpack all items from the box and reference the parts list to ensure all parts are present before continuing installation.
2. Place all parts onto a clean, protected work surface.
3. Place the Rubber Bases (10) onto each end of the Standing Bracket (9).
4. Place the Standing Bracket (9) within the inlet of the Standing Block (8). Align the holes on the Bracket (9) and the Block (8) and secure with the Standing Bracket Bolt (7).
5. Insert the threaded end of the Standing Bracket assembly (completed step # 4) into the gap on one end of the Beam (1).
6. Place a Lock Knob Washer (3) over the threaded end of the Standing Bracket assembly. Fasten the assembly using a Lock Knob (2).
7. Repeat steps 3-6 to assemble the second Standing Bracket.
8. Insert the threaded end of the J-Hook (11) into the center gap of the Beam (1). Place a J-Hook Washer (6) over the threaded end, and fasten with the Grip Handle (5). Repeat for the second J-Hook (11).

NOTE: It is not necessary to tighten the Grip Handle completely. The Grip Handle/J-Hook assembly defines the engine support height.

9. Place the Handle Sleeves (4) over each end of the Grip Handles (5).
10. Hang each Chain (12) from the J-Hooks (11).

OPERATION INSTRUCTIONS

▲ WARNING: OEMTOOLS™ is not responsible for damage to the vehicle or paint finish. The user must understand that by using this product, they are accepting the risks involved with vehicle maintenance and repair. There are outlying factors that cannot be discussed or defined by this product manual. Always refer to the vehicle maintenance manual, and utilize best judgment prior to attempting any maintenance or repair.

1. Park the vehicle on a flat surface. Apply the parking brake and chock the wheels.

2. Allow the engine to cool sufficiently prior to repair or maintenance.

▲ WARNING: Working on hot engine components can cause serious injury.

3. Inspect the inner fender channel for a flat area that can support the weight of the engine and the Engine Support Bar.

▲ WARNING: DO NOT place the supports on the outer fender. This can cause damage to the vehicle and may lead to product failure.

4. Center the Engine Support Bar over the Engine and extend the Standing Brackets to the points identified in Step # 3. Ensure the Standing Brackets are securely tightened in place after adjustment.

5. Attach the Engine Support Chains to the engine.

NOTE: Reference the vehicle maintenance manual to identify the proper lifting points.

6. Attach the ends of the chains to the J-Hooks.
7. Slowly rotate the Grip Handles clockwise until the chains are taut and the engine is held evenly and securely.
8. While loosening the engine mounts, adjust the Grip Handles with ¼-inch turns until the engine's weight is supported and evenly distributed between the two chains.
9. When maintenance is complete, lower the engine to reconnect mounts.

PRODUCT STORAGE

Always store the Engine Support Bar in a well-protected area where it will not be exposed to inclement weather, corrosive vapors, abrasive dust, fire or any other harmful elements.

PRODUCT MAINTENANCE

▲ WARNING: DO NOT attempt to modify the Engine Support Bar in any way.

1. Lubrication:
 - a. J-Hook and Grip Handle – Lubricate the threaded portion of the J-Hook to ensure smooth rotation. Added friction may strip the threading over periods of use which may lead to product failure.
 - b. Standing Block Connection – Lightly lubricate the threaded portion of the Standing Block Connection to allow the Block to slide smoothly along the Beam.
2. Cleaning: Periodically check the Engine Support Bar for rust or corrosion. Clean as needed and wipe with light oil.

DISPOSAL

At the end of the useful life of the OEMTOOLS™ Engine Support Bar, dispose of the components in accordance with all federal, state and local regulations.



1100 LB. ENGINE SUPPORT BAR

PRODUCT LAYOUT

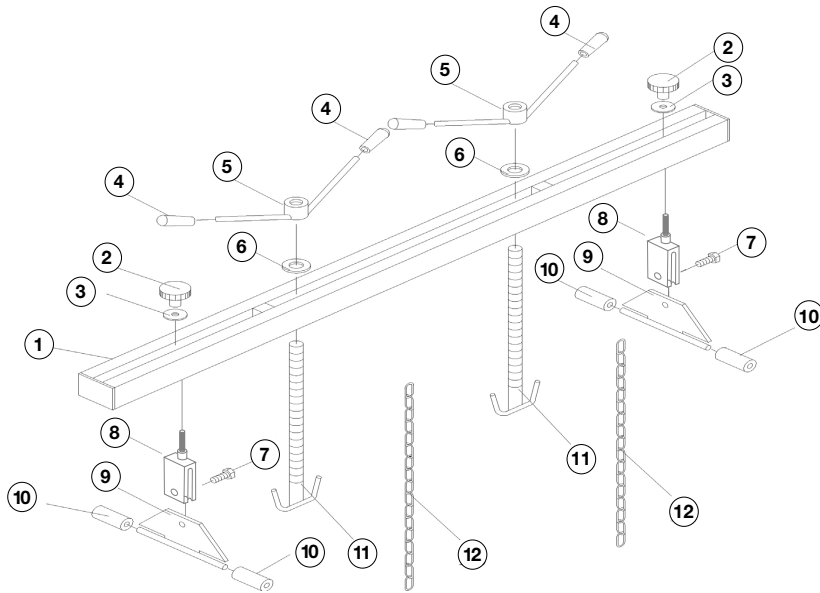

PARTS DESCRIPTION

Figure	Description	Qty.
1	Beam	1
2	Lock Knob	2
3	Lock Knob Washer	2
4	Handle Sleeve	4
5	Grip Handle	2
6	J-Hook Washer	2
7	Standing Bracket Bolt	2
8	Standing Block	2
9	Standing Bracket	2
10	Rubber Base	4
11	J-Hook	2
12	Chain	2

OEMTOOLS™ 90 DAY Limited Warranty

For up to 90 days from the original purchase of this OEMTOOLS™ product, if you find any defect in material or workmanship (through normal usage), return it to the place of purchase or to OEMTOOLS™ for repair or replacement at our discretion. In order to obtain this service, send your tool and proof of purchase (transportation pre-paid) to:

OEMTOOLS™ Q.A. Dept., 3580 E. Raines Road #3, Memphis, TN 38118.

We will not be responsible for lost or damaged goods during transportation; please insure your package. If our inspection verifies the defect, we will either repair or replace the product, or we may elect to refund the purchase price if we cannot readily and quickly provide you with a replacement. We will return repaired products at our expense, but if we determine there is no defect, or that the defect resulted from causes not within the scope of our warranty, then you must bear the cost of returning the product.

OEMTOOLS™ does not provide warranty for products labeled other than OEM® or OEMTOOLS™. OEMTOOLS™ will not provide any warranty for products subjected to abnormal use. Abnormal use includes (but is not limited to) abuse, accident, alteration, neglect, and unauthorized or unreasonable use or repairs. This warranty does not cover bits, blades, files, batteries, or calibration. We recommend that you maintain your tools and sharpen or replace blades, bits, files, and batteries as necessary. OEMTOOLS™ reserves the right to make any changes in construction or design at any time without any obligation in incorporating such changes to tools or equipment previously sold.

OEMTOOLS™ makes every effort to ensure that its products meet high quality and durability standards, and warrants to the original purchaser that this product is free from defects in materials and workmanship for the period of 90 days from the date of purchase. This warranty does not apply to damage due directly or indirectly to misuse, abuse, negligence or accidents, repairs or alterations outside our facilities, criminal activity, improper installation, normal wear and tear or to lack of maintenance.

We shall in no event be liable for death, injuries to persons or property, or for incidental, contingent, special or consequential damages arising from the use of our product. Some states do not allow the exclusion or limitation of incidental or consequential damages, so the above limitation of exclusion may not apply to you. THIS WARRANTY IS EXPRESSLY IN LIEU OF ALL OTHER WARRANTIES, EXPRESS OR IMPLIED, INCLUDING THE WARRANTIES OF MERCHANTABILITY AND FITNESS. This warranty gives you specific legal rights, and you may also have other rights, which vary from state to state.

Don't forget to register your new OEMTOOLS™ product at www.oem-tools.com.

CONTACT US

3580 E. Raines Road, Suite 3, Memphis, TN 38118
 Tel: 1-866-458-2472
www.oem-tools.com